

The Chadwick

- 1,554 sq. feet of living space
- 3 bedrooms, 2 full baths
- Hexagonal, turret-like bay on front bedroom
- Interesting windows, some arched, others with gabled pediments
- Covered front and rear porches
- Open plan with dining room, living room and morning room surrounding kitchen
- Vaulted ceilings
- Master suite with large walk-in closet
- First-floor laundry/utility room
- Storage shed



NEIGHBORHOOD PLAN

Any Park DuValle builder can build this striking Victorian home.

The Chadwick options

- Basement
- Vinyl siding or brick exterior

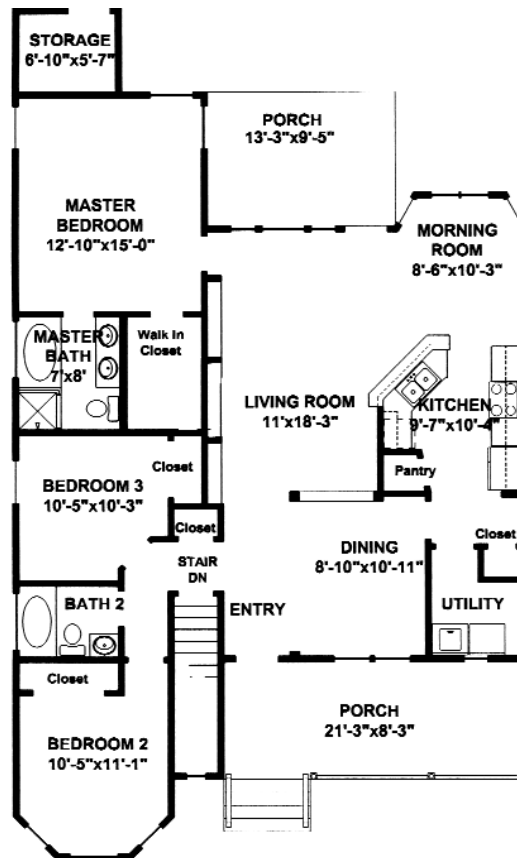

FOR MORE INFORMATION, CALL 515-1979, EXT. 10

Please ask for additional house plans that may be available.